

For Completion



LOCATION DIAGRAM  
Scale 1:5000



Plan No	Rev	Plan Title
<b>Earthworks</b>		
9000	1	Overall Final Contours As-Built Plan
9001	0	Enlarged Final Contours As-Built Plan Sheet 1
9002	1	Enlarged Final Contours As-Built Plan Sheet 2
9003	0	Enlarged Final Contours As-Built Plan Sheet 3
9010	1	Overall Cut to Fill As-Built Plan
9011	1	Enlarged Cut to Fill As-Built Plan Sheet 1
9012	1	Enlarged Cut to Fill As-Built Plan Sheet 2
9013	1	Enlarged Cut to Fill As-Built Plan Sheet 3
<b>Roading</b>		
9100	0	Overall Roading As-Built Plan
9101	0	Enlarged Roading As-Built Plan
<b>Wastewater</b>		
9200	2	Overall PWC Sewer As-Built Plan
9201	2	Enalrged PWC Sewer As-Built Plan
<b>Stormwater</b>		
9300	0	Overall Stormwater As-Built Plan
9301	1	Enlarged Stormwater As-Built Plan Sheet 1
9302	0	Enlarged Stormwater As-Built Plan Sheet 2
9303	1	Enlarged Stormwater & Raingarden As-Built Details
<b>Water Reticulation</b>		
9400	2	Overall Water Reticulation As-Built Plan
9401	2	Enlarged Water Reticulation As-Built Plan
<b>Zone of Influence</b>		
9800	0	Overall Zone of Influence As-Built Plan
9801	0	Enlarged Zone of Influence As-Built Plan Sheet 1
9802	0	Enlarged Zone of Influence As-Built Plan Sheet 2

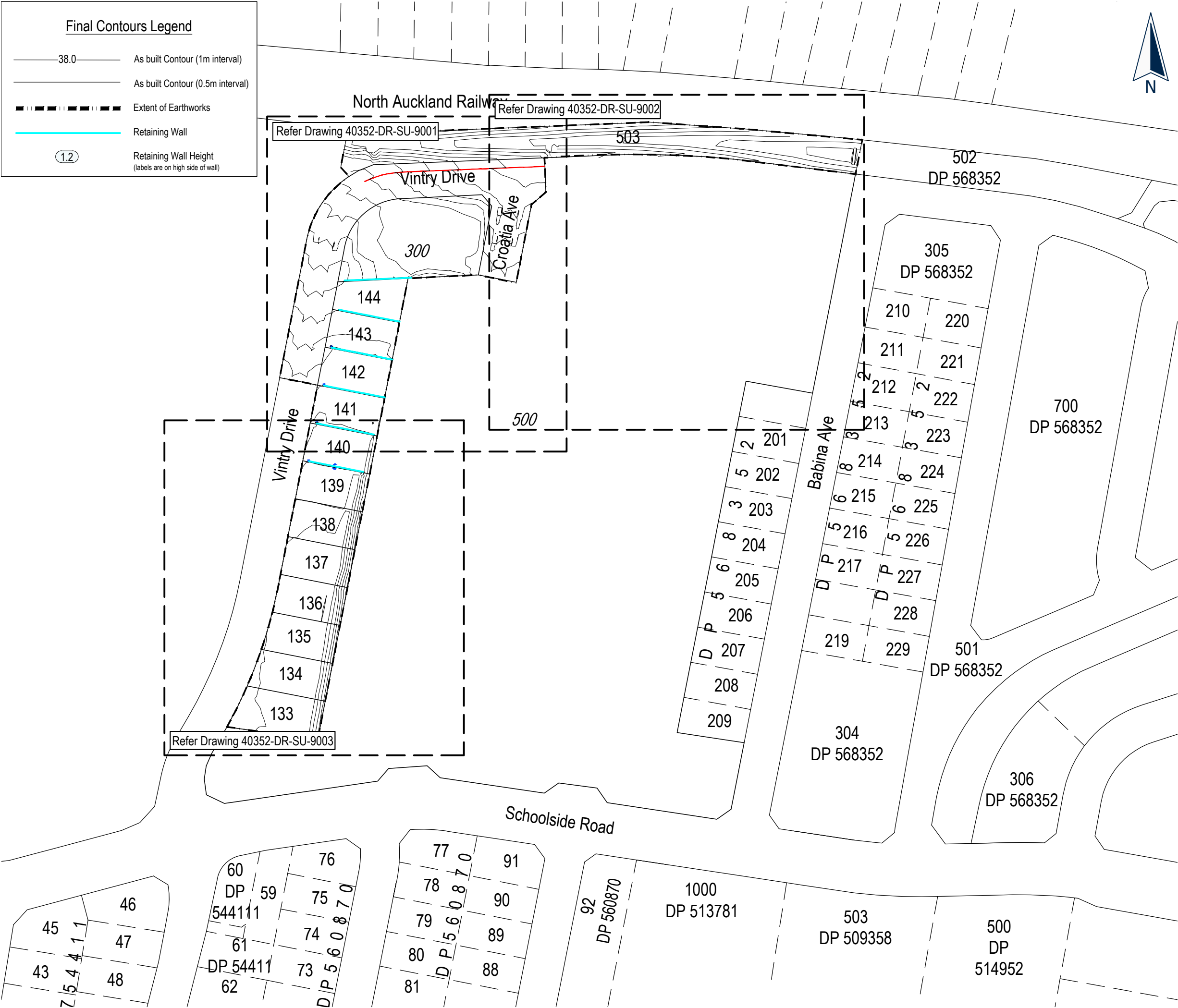

This drawing and design remains the property of, and may not be reproduced or amended without the written permission of Cato Bolam Consultants Ltd. No liability shall be accepted for unauthorised use of this drawing and design.



ENG60388149 / BUN60318445

I certify that these As-Built Plans are an accurate record of the works undertaken and that:

- \* The Coordinates (X, Y) are in terms of NZTM on NZGD(2000), and are within  $\pm 50$ mm.
- \* The levels (Z) are in terms of the Auckland 1946 (MSL) LINZ datum (DOSLI datum), and are within  $\pm 10$ mm.

Signed:   
Licensed Cadastral Surveyor

Date: 09/12/2022

Name: Brad Mowat  
Phone : (09) 427 0072  
Email : BradM@catobolam.co.nz



PLANNERS | SURVEYORS | ENGINEERS  
ARCHITECTS | ENVIRONMENTAL

**Cabra Developments Limited**  
22 Vintry Drive  
Huapai

**Overall  
Final Contours  
As-Built Plan**

**FOR COMPLETION**

No.	REVISION (DESCRIPTIONS)	NAME	DATE
0	Issued For Completion	K.Middeldorp	02/12/2022
1	Issued For Completion	K.Middeldorp	09/12/2022
SURVEYED		H.Baker	07/11/2022
DESIGNED		E.Greene	06/07/2021
DRAWN		B.Nel	09/11/2022
DATE		ORIGINAL SCALE	ORIGINAL SIZE
09/11/2022		1:1500	A3
DRAWING NO.			REVISION
40352-DR-SU-9000			1

Final Contours Legend

38.0

As built Contour (1m interval)

As built Contour (0.5m interval)

Extent of Earthworks

Retaining Wall

(1.2)

Retaining Wall Height  
(labels are on high side of wall)

This drawing and design remains the property of, and may not be reproduced or amended without the written permission of Cato Bolam Consultants Ltd. No liability shall be accepted for unauthorised use of this drawing and design.

CABRA

Land & Property Development

ENG60388149 /BUN60318445

I certify that these As-Built Plans are an accurate record of the works undertaken and that:

\* The Coordinates (X, Y) are in terms of NZTM on NZGD(2000), and are within ± 50mm.

\* The levels (Z) are in terms of the Auckland 1946 (MSL) LINZ datum (DOSLI datum), and are within ± 10mm.

Signed:

Registered Professional Surveyor

Date: 02/12/2022

Name: Kerryn McPherson

Phone : (09) 427 0072

Email : KerrynM@catobolam.co.nz

Cato Bolam

creating great places

PLANNERS | SURVEYORS | ENGINEERS

ARCHITECTS | ENVIRONMENTAL

Cabra Developments Limited

22 Vintry Drive

Huapai

Enlarged Final Contours

As-Built Plan

Sheet 1

FOR COMPLETION

No.	REVISION (DESCRIPTIONS)	NAME	DATE
0	Issued For Completion	K.Middeldorp	02/12/2022

SURVEYED	H.Baker	07/11/2022
DESIGNED	E.Greene	06/07/2021
DRAWN	B.Nel	09/11/2022

DATE	ORIGINAL SCALE	ORIGINAL SIZE
09/11/2022	1:500	A3

DRAWING NO.	REVISION
40352-DR-SU-9001	0

C:\120synergy\workspaces\40352 - cabra stg 2 sub preprod a - 10495\technical\Drawings\as-built drawings\40352-DR-SU-9001-9003 Final Contours As-Built

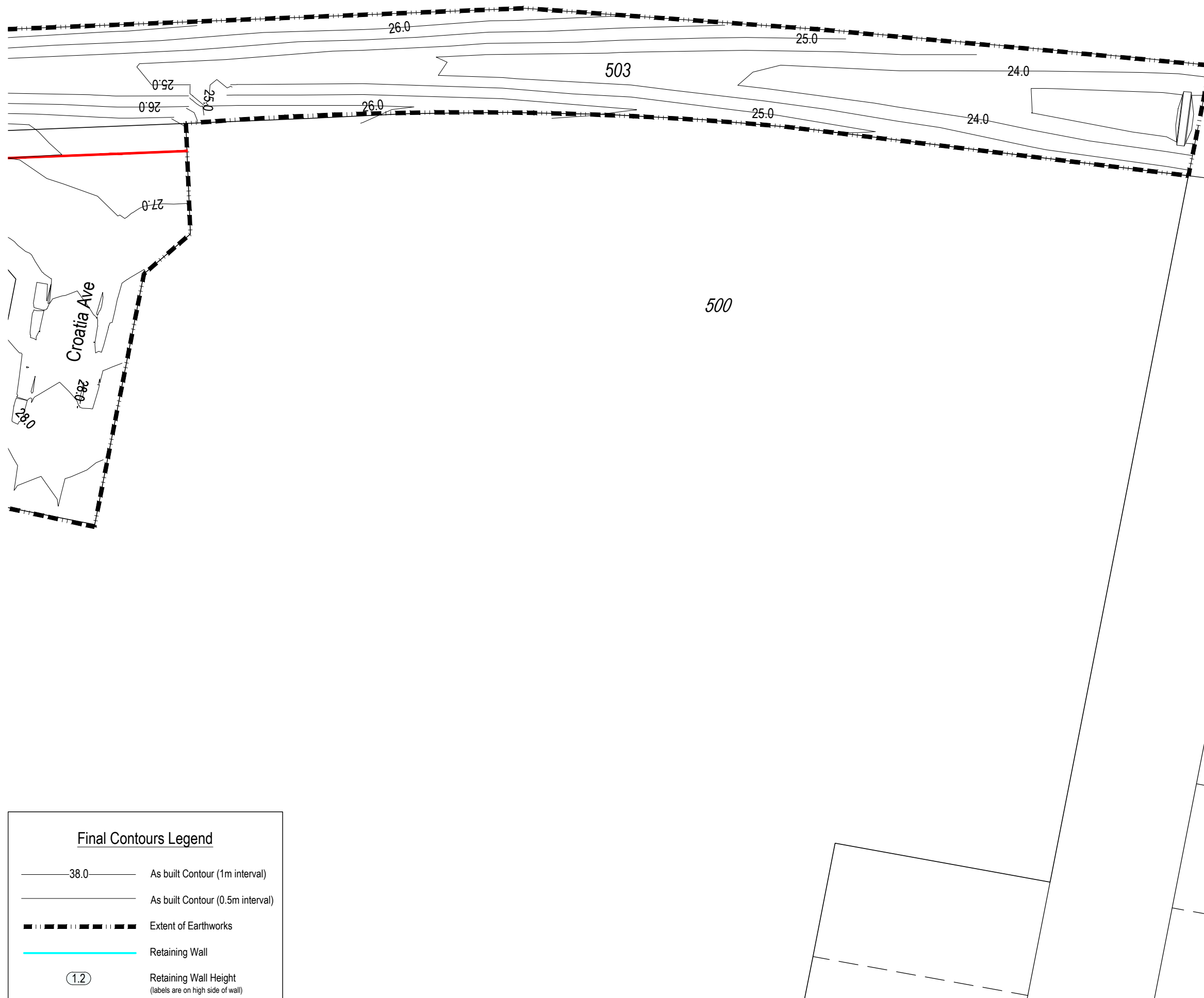

Final Contours Legend

38.0

As built Contour (1m interval)

As built Contour (0.5m interval)

Extent of Earthworks

Retaining Wall

(1.2)

Retaining Wall Height  
(labels are on high side of wall)



ENG60388149 /BUN60318445

I certify that these As-Built Plans are an accurate record of the works undertaken and that:

- \* The Coordinates (X, Y) are in terms of NZTM on NZGD(2000), and are within ± 50mm.
- \* The levels (Z) are in terms of the Auckland 1946 (MSL) LINZ datum (DOSLI datum), and are within ± 10mm.

Signed:   
Licensed Cadastral Surveyor

Date: 09/12/2022

Name: Brad Mowat  
Phone : (09) 427 0072  
Email : BradM@catobolam.co.nz



PLANNERS | SURVEYORS | ENGINEERS  
ARCHITECTS | ENVIRONMENTAL

Cabra Developments Limited  
22 Vintry Drive  
Huapai

Enlarged Final Contours  
As-Built Plan  
Sheet 2

FOR COMPLETION

No.	REVISION (DESCRIPTIONS)	NAME	DATE
0	Issued For Completion	K.Middeldorp	02/12/2022
1	Issued For Completion	K.Middeldorp	09/12/2022
SURVEYED		H.Baker	07/11/2022
DESIGNED		E.Greene	06/07/2021
DRAWN		B.Nel	09/11/2022
DATE		ORIGINAL SCALE	ORIGINAL SIZE
09/11/2022		1:500	A3
DRAWING NO.			REVISION
40352-DR-SU-9002			1

C:\125\Synergy\Workspaces\cabra\CAT\APPI\40352 - Cabra - Sig 2 Sub Precinct A - 104951\Technical\Drawings\As-Built Drawings\40352-DR-SU-9002-9003 Final Contours As-Built



Final Contours Legend

38.0

As built Contour (1m interval)

As built Contour (0.5m interval)

Extent of Earthworks

Retaining Wall

1.2

Retaining Wall Height  
(labels are on high side of wall)

1  
DP 533552

Vintry Drive

500

This drawing and design remains the property of, and may not be reproduced or amended without the written permission of Cato Bolam Consultants Ltd. No liability shall be accepted for unauthorised use of this drawing and design.

ENG60388149 /BUN60318445

I certify that these As-Built Plans are an accurate record of the works undertaken and that:

- \* The Coordinates (X, Y) are in terms of NZTM on NZGD(2000), and are within ± 50mm.
- \* The levels (Z) are in terms of the Auckland 1946 (MSL) LINZ datum (DOSLI datum), and are within ± 10mm.

Signed:   
Registered Professional Surveyor

Date: 02/12/2022

Name: Kerryn McPherson  
Phone : (09) 427 0072  
Email : KerrynM@catobolam.co.nz

Cato Bolam

creating great places

PLANNERS | SURVEYORS | ENGINEERS  
ARCHITECTS | ENVIRONMENTAL

Cabra Developments Limited  
22 Vintry Drive  
Huapai

Enlarged Final Contours  
As-Built Plan  
Sheet 3

FOR COMPLETION

No.	REVISION (DESCRIPTIONS)	NAME	DATE
0	Issued For Completion	K.Middeldorp	02/12/2022
SURVEYED		H.Baker	07/11/2022
DESIGNED		E.Greene	06/07/2021
DRAWN		B.Nel	09/11/2022
DATE		ORIGINAL SCALE	ORIGINAL SIZE
09/11/2022		1:500	A3
DRAWING NO.			REVISION
40352-DR-SU-9003			0

C:\123synergy\workspaces\data\CA\TAPPI\40352 - cabra.stj 2 sub preend a\_10495\technical\Drawings\as-built drawings\40352-DR-SU-9003-9003 Final Contours As-Built

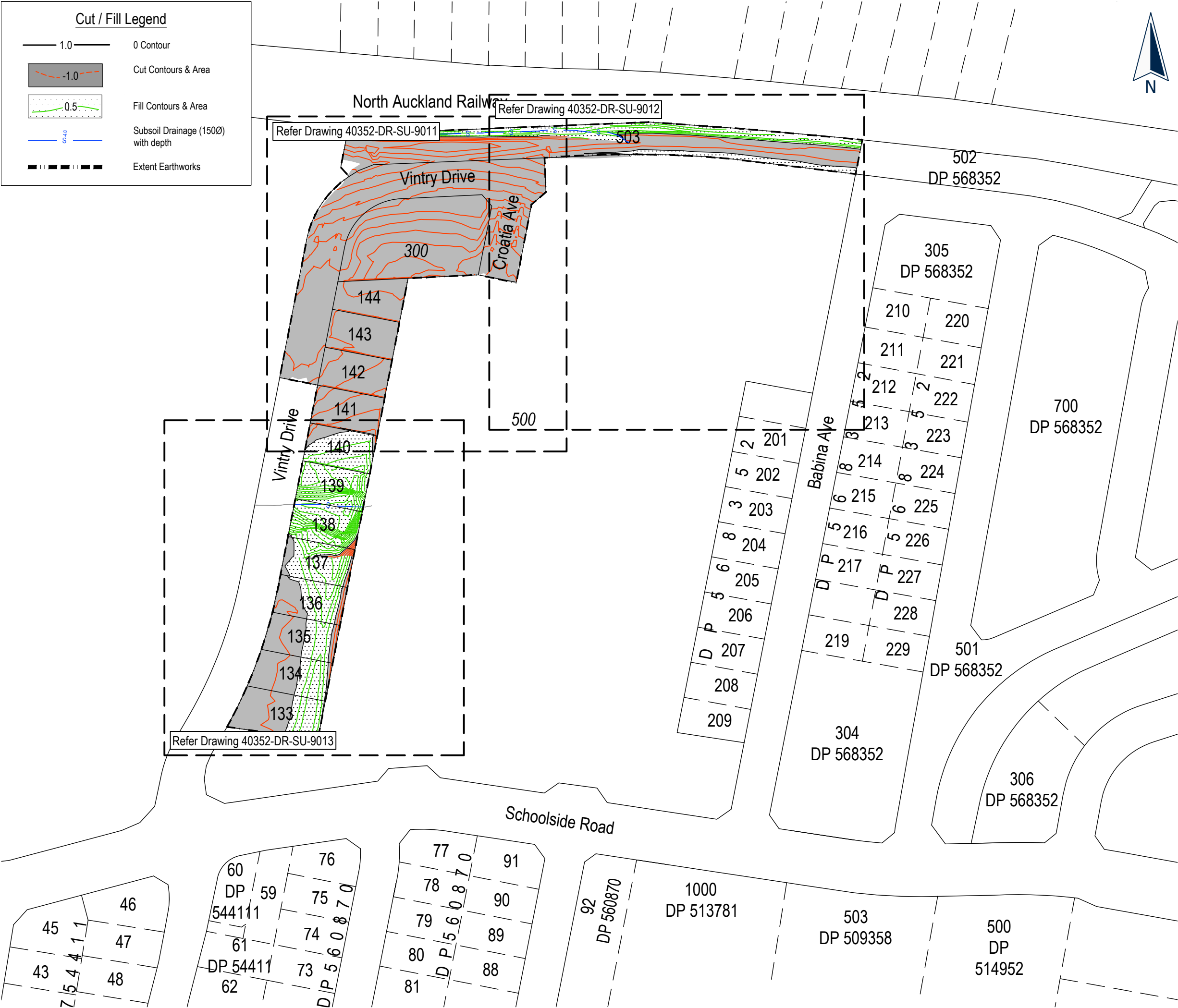

This drawing and design remains the property of, and may not be reproduced or amended without the written permission of Cato Bolam Consultants Ltd. No liability shall be accepted for unauthorised use of this drawing and design.



ENG60388149 /BUN60318445

I certify that these As-Built Plans are an accurate record of the works undertaken and that:

- \* The Coordinates (X, Y) are in terms of NZTM on NZGD(2000), and are within ± 50mm.
- \* The levels (Z) are in terms of the Auckland 1946 (MSL) LINZ datum (DOSLI datum), and are within ± 10mm.

Signed:   
Registered Professional Surveyor

Date: 07/12/2022

Name: Kerryn McPherson  
Phone : (09) 427 0072  
Email : KerrynM@catobolam.co.nz



PLANNERS | SURVEYORS | ENGINEERS  
ARCHITECTS | ENVIRONMENTAL

Cabra Developments Limited  
22 Vintry Drive  
Huapai

Overall  
Cut to Fill  
As-Built Plan

FOR COMPLETION

No.	REVISION (DESCRIPTIONS)	NAME	DATE
0	Issued For Completion	K.Middeldorp	02/12/2022
1	Updated subsoil depths and undercut	K.Middeldorp	07/12/2022
SURVEYED		H.Baker	07/11/2022
DESIGNED		E.Greene	06/07/2021
DRAWN		B.Nel	08/11/2022
DATE		ORIGINAL SCALE	ORIGINAL SIZE
08/11/2022		1:1500	A3
DRAWING NO.			REVISION
40352-DR-SU-9010			1

Cut / Fill Legend

1.0

0 Contour

-1.0

Cut Contours & Area

0.5

Fill Contours & Area

0.40

Subsoil Drainage (150Ø)  
with depth

Extent Earthworks

The main site plan shows a large area with various contour lines and subsoil drainage details. The plan includes labels for 'Vintry Drive', 'Croatia Ave', and several numbered areas (140, 141, 142, 143, 144, 300, 500, 503). The contours are color-coded: red for cut and green for fill. Subsoil drainage is shown as blue lines with depth values. The extent of earthworks is indicated by a dashed black line. A north arrow is located in the top right corner.

This drawing and design remains the property of, and may not be reproduced or amended without the written permission of Cato Bolam Consultants Ltd. No liability shall be accepted for unauthorised use of this drawing and design.

CABRA

Land & Property Development

ENG60388149 /BUN60318445

I certify that these As-Built Plans are an accurate record of the works undertaken and that:

\* The Coordinates (X, Y) are in terms of NZTM on NZGD(2000), and are within ± 50mm.

\* The levels (Z) are in terms of the Auckland 1946 (MSL) LINZ datum (DOSLI datum), and are within ± 10mm.

Signed:

Registered Professional Surveyor

Date: 07/12/2022

Name: Kerryn McPherson

Phone : (09) 427 0072

Email : KerrynM@catobolam.co.nz

Cato Bolam

creating great places

PLANNERS | SURVEYORS | ENGINEERS

ARCHITECTS | ENVIRONMENTAL

Cabra Developments Limited

22 Vintry Drive

Huapai

Enlarged Cut to Fill

As-Built Plan

Sheet 1

FOR COMPLETION

No.	REVISION (DESCRIPTIONS)	NAME	DATE
0	Issued For Completion	K.Middeldorp	02/12/2022
1	Updated subsoil depths and undercut	K.Middeldorp	07/12/2022

SURVEYED	H.Baker	07/11/2022
DESIGNED	E.Greene	06/07/2021
DRAWN	B.Nel	08/11/2022

DATE	ORIGINAL SCALE	ORIGINAL SIZE
08/11/2022	1:500	A3

DRAWING NO.	REVISION
40352-DR-SU-9011	1

C:\125\Synergy\data\CA\TOAPP\40352 - Cabra Sty 2 Sub-Printed A - 104951\Technical\Drawings\As-Built Drawings\40352-DR-SU-9011-9013 Cut to Fill As-Built

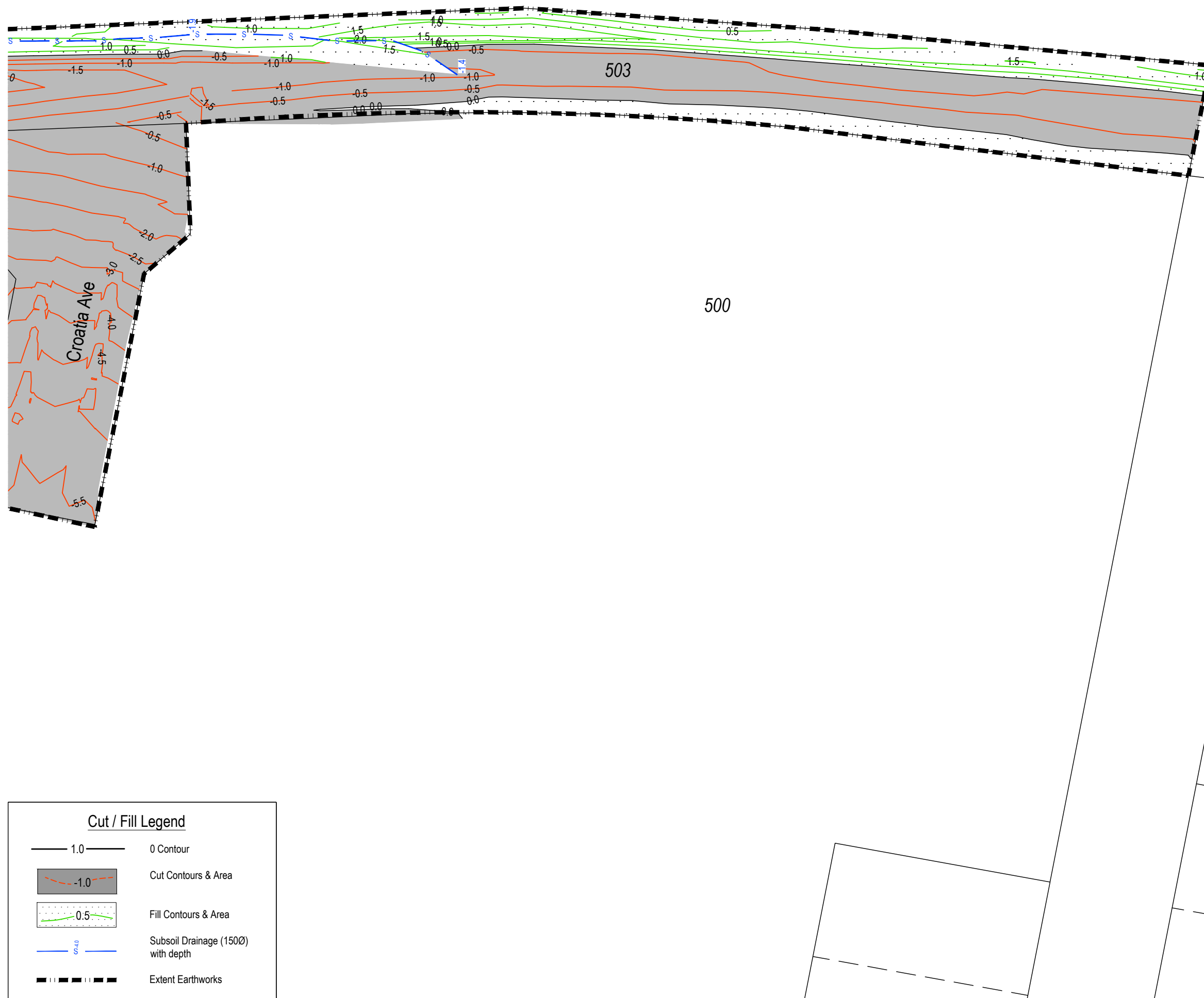

1.0

Cut Contours & Area

0.5

Fill Contours & Area

0.40

Subsoil Drainage (150Ø)  
with depth

Extent Earthworks

Cut / Fill Legend

C:\12\Synergy\data\CA\TOAPP\10352 - Cabra\_Sht 2 Sub-Printed A - 10451\Technical\Drawings\As-Built Drawings\40352-DR-SU-9012-Cut to Fill As-Built

This drawing and design remains the property of, and may not be reproduced or amended without the written permission of Cato Bolam Consultants Ltd. No liability shall be accepted for unauthorised use of this drawing and design.



ENG60388149 /BUN60318445

I certify that these As-Built Plans are an accurate record of the works undertaken and that:

- \* The Coordinates (X, Y) are in terms of NZTM on NZGD(2000), and are within ± 50mm.
- \* The levels (Z) are in terms of the Auckland 1946 (MSL) LINZ datum (DOSLI datum), and are within ± 10mm.

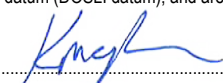
Signed:   
Registered Professional Surveyor

Date: 07/12/2022

Name: Kerryn McPherson  
Phone : (09) 427 0072  
Email : KerrynM@catobolam.co.nz



PLANNERS | SURVEYORS | ENGINEERS  
ARCHITECTS | ENVIRONMENTAL

Cabra Developments Limited  
22 Vintry Drive  
Huapai

Enlarged Cut to Fill  
As-Built Plan  
Sheet 2

FOR COMPLETION

No.	REVISION (DESCRIPTIONS)	NAME	DATE
0	Issued For Completion	K.Middeldorp	02/12/2022
1	Updated subsoil depths and undercut	K.Middeldorp	07/12/2022
SURVEYED		H.Baker	07/11/2022
DESIGNED		E.Greene	06/07/2021
DRAWN		B.Nel	08/11/2022
DATE		ORIGINAL SCALE	ORIGINAL SIZE
08/11/2022		1:500	A3
DRAWING NO.			REVISION
40352-DR-SU-9012			1



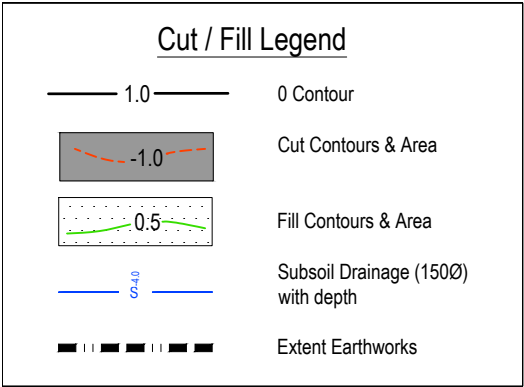

1  
DP 533552

Vintry Drive

500



This drawing and design remains the property of, and may not be reproduced or amended without the written permission of Cato Bolam Consultants Ltd. No liability shall be accepted for unauthorised use of this drawing and design.



ENG60388149 /BUN60318445

I certify that these As-Built Plans are an accurate record of the works undertaken and that:

- \* The Coordinates (X, Y) are in terms of NZTM on NZGD(2000), and are within  $\pm 50\text{mm}$ .
- \* The levels (Z) are in terms of the Auckland 1946 (MSL) LINZ datum (DOSLI datum), and are within  $\pm 10\text{mm}$ .

Signed:   
Registered Professional Surveyor

Date: 07/12/2022

Name: Kerryn McPherson  
Phone : (09) 427 0072  
Email : KerrynM@catobolam.co.nz



PLANNERS | SURVEYORS | ENGINEERS  
ARCHITECTS | ENVIRONMENTAL

Cabra Developments Limited  
22 Vintry Drive  
Huapai

Enlarged Cut to Fill  
As-Built Plan  
Sheet 3

FOR COMPLETION

No.	REVISION (DESCRIPTIONS)	NAME	DATE
0	Issued For Completion	K.Middeldorp	02/12/2022
1	Updated subsoil depths and undercut	K.Middeldorp	07/12/2022
SURVEYED		H.Baker	07/11/2022
DESIGNED		E.Greene	06/07/2021
DRAWN		B.Nel	08/11/2022
DATE		ORIGINAL SCALE	ORIGINAL SIZE
08/11/2022		1:500	A3
DRAWING NO.			REVISION
40352-DR-SU-9013			1

C:\125\Synergy\data\CA\TOAPP\40352 - Cabra St3 2 Sub-Printed A - 104561\Technical\Drawings\As-Built Drawings\40352-DR-SU-9013 Cut to Fill As-Built

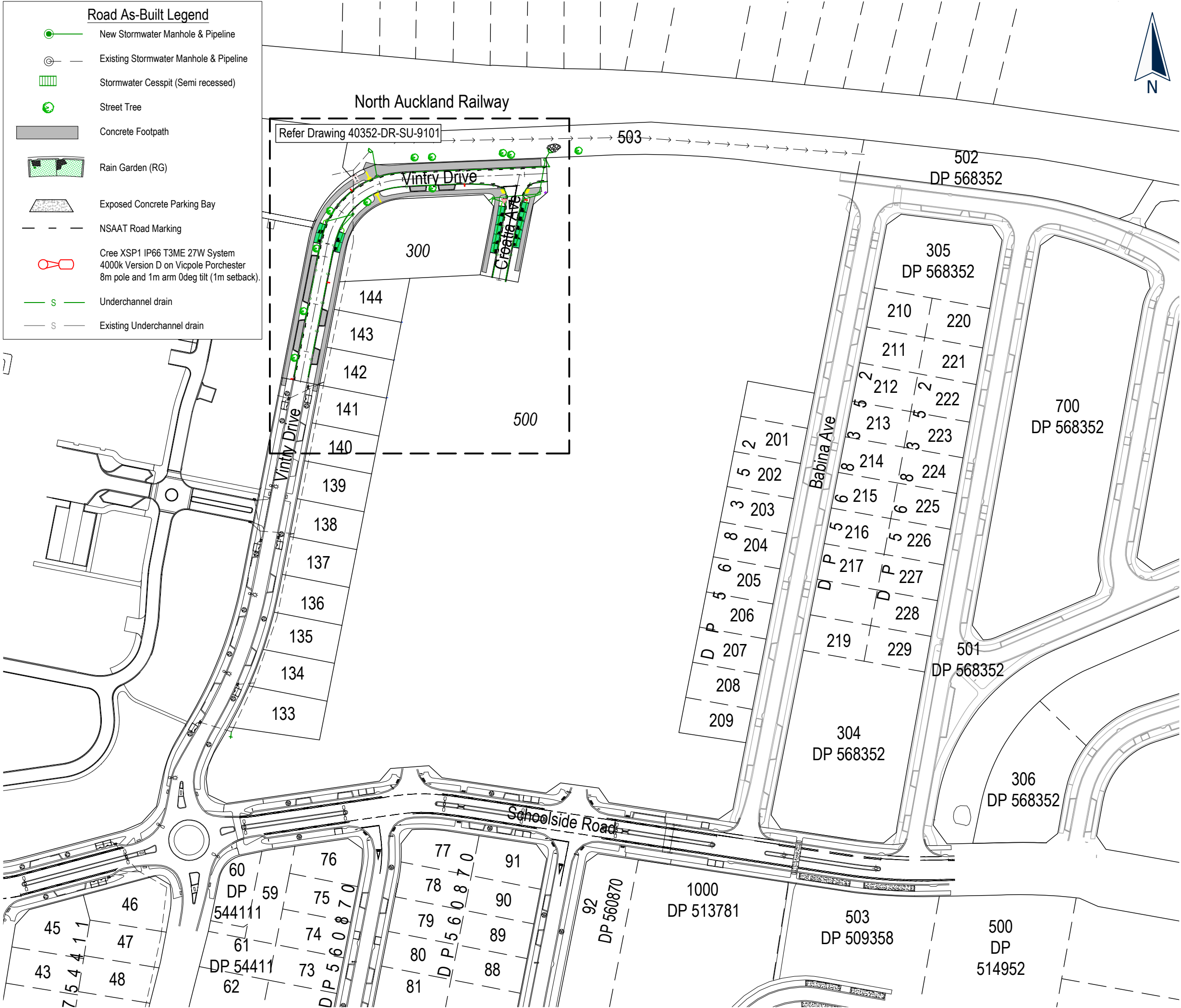

This drawing and design remains the property of, and may not be reproduced or amended without the written permission of Cato Bolam Consultants Ltd. No liability shall be accepted for unauthorised use of this drawing and design.



ENG60388149 /BUN60318445

I certify that these As-Built Plans are an accurate record of the works undertaken and that:  
\* The Coordinates (X, Y) are in terms of NZTM on NZGD(2000), and are within ± 50mm.  
\* The levels (Z) are in terms of the Auckland 1946 (MSL) LINZ datum (DOSLI datum), and are within ± 10mm.

Signed: *[Signature]*  
Registered Professional Surveyor

Date: 02/12/2022

Name: Kerryn McPherson  
Phone : (09) 427 0072  
Email : KerrynM@catobolam.co.nz

**Cato Bolam**  
creating great places  
PLANNERS | SURVEYORS | ENGINEERS  
ARCHITECTS | ENVIRONMENTAL

Cabra Developments Limited  
22 Vintry Drive  
Huapai

Overall  
Roothing  
As-Built Plan

FOR COMPLETION

No.	REVISION (DESCRIPTIONS)	NAME	DATE
0	Issued For Completion	K.Middeldorp	02/12/2022
SURVEYED		H.Baker	07/11/2022
DESIGNED		E.Greene	06/07/2021
DRAWN		B.Nel	08/11/2022
DATE		ORIGINAL SCALE	ORIGINAL SIZE
08/11/2022		1:1500	A3
DRAWING NO.			REVISION
40352-DR-SU-9100			0



ENG60388149 /BUN60318445

I certify that these As-Built Plans are an accurate record of the works undertaken and that:

- \* The Coordinates (X, Y) are in terms of NZTM on NZGD(2000), and are within  $\pm 50$ mm.
- \* The levels (Z) are in terms of the Auckland 1946 (MSL) LINZ datum (DOSLI datum), and are within  $\pm 10$ mm.

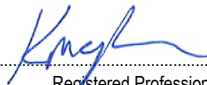
Signed:   
Registered Professional Surveyor

Date: 02/12/2022

Name: Kerryn McPherson  
Phone : (09) 427 0072  
Email : KerrynM@catobolam.co.nz



PLANNERS | SURVEYORS | ENGINEERS  
ARCHITECTS | ENVIRONMENTAL

Cabra Developments Limited  
22 Vintry Drive  
Huapai











Enlarged  
Roothing  
As-Built Plan

FOR COMPLETION

No.	REVISION (DESCRIPTIONS)	NAME	DATE
0	Issued For Completion	K.Middeldorp	02/12/2022
SURVEYED		H.Baker	07/11/2022
DESIGNED		E.Greene	06/07/2021
DRAWN		B.Nel	08/11/2022
DATE		ORIGINAL SCALE	ORIGINAL SIZE
08/11/2022		1:500	A3
DRAWING NO.			REVISION
40352-DR-SU-9101			0

C:\120\Synergy\Workspaces\Cato\BPP\40352 - Cabra - Sig 2 Sub Precinct A - 104951 Technical Drawings\As-Built Drawings\40352-DR-SU-9101-9101 Road As-Built

## Road As-Built Legend

-  New Stormwater Manhole & Pipeline
-  Existing Stormwater Manhole & Pipeline
-  Stormwater Cesspit (Semi recessed)
-  Street Tree
-  Concrete Footpath
-  Rain Garden (RG)
-  Exposed Concrete Parking Bay
-  NSAAT Road Marking
-  Cree XSP1 IP66 T3ME 27W System 4000k Version D on Vicpole Porchester 8m pole and 1m arm 0deg tilt (1m setback).
-  Underchannel drain
-  Existing Underchannel drain

## NOTES

### GENERAL

1. Levels are in terms of LINZ Datum 1946.
2. Coordinates are in terms of NZTM.
3. All infrastructure is public unless otherwise shown.

### Road Footpaths

1.8m wide, 100mm 20MPa concrete on 100mm GAP40 bedding  
3.0m wide, 125mm 20MPa concrete, with 1 layer off 665 mesh on 100mm GAP40 bedding

### Parking Bays

175mm 20 MPa exposed concrete with 4kg/m<sup>2</sup> black oxide, 1 layer of 665 mesh on 100mm GAP 65 Subbase

### Roads

Subgrade - Stabilised with 12kg/m<sup>2</sup> of Lime and 4kg/m<sup>2</sup> of cement  
Subbase - 200mm GAP65  
Basecourse - 150mm TNZ AP40  
Seal - 40mm DG10 asphaltic concrete on grade 4 chipseal membrane

Streetlight Coordinate Table

Streetlight No	mN	mE
SL2	5929137.25	1737455.24
SL3	5929176.69	1737471.77
SL4	5929215.18	1737481.23
SL11	5929215.58	1737528.43
SL13	5929209.35	1737554.18

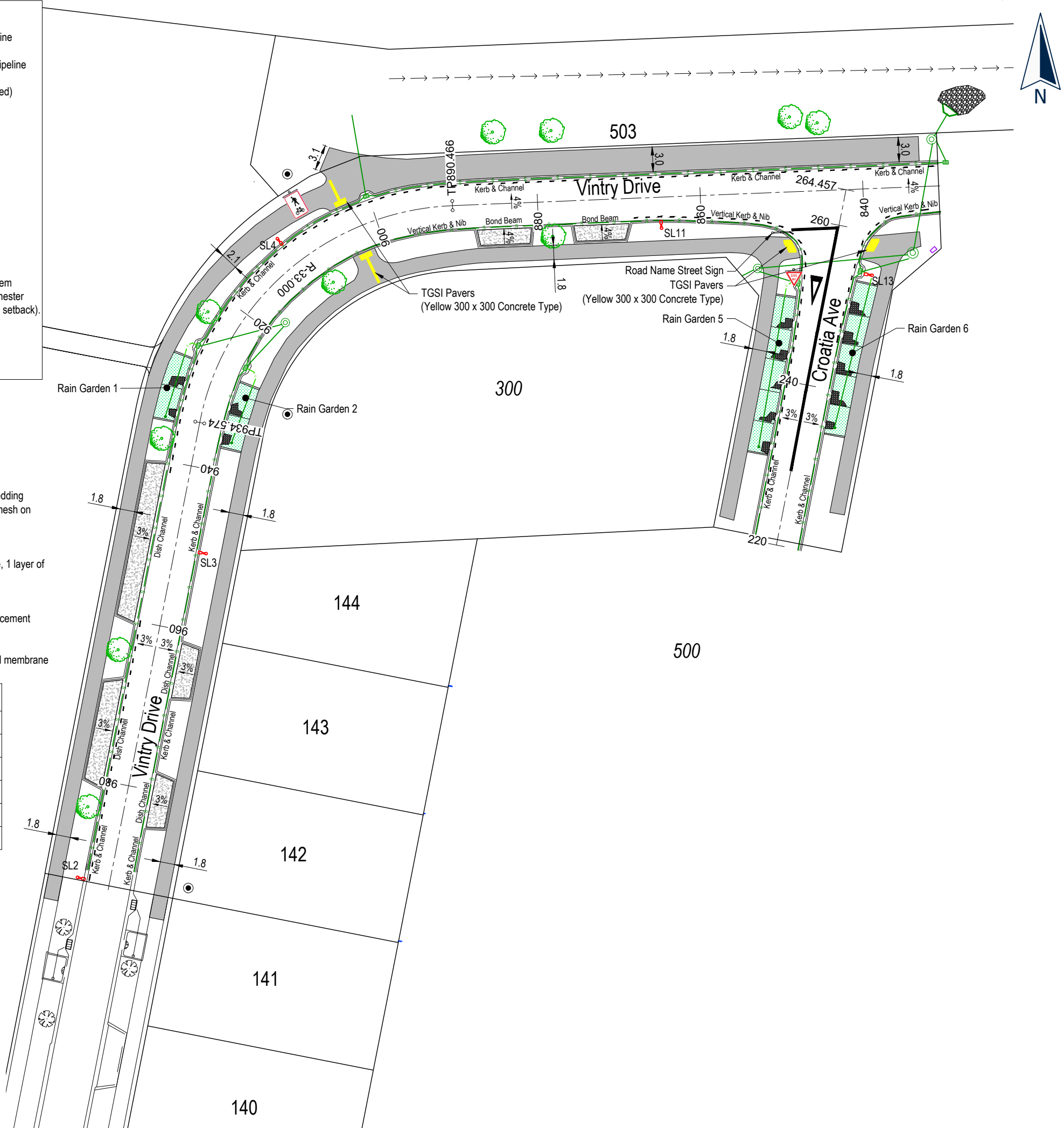



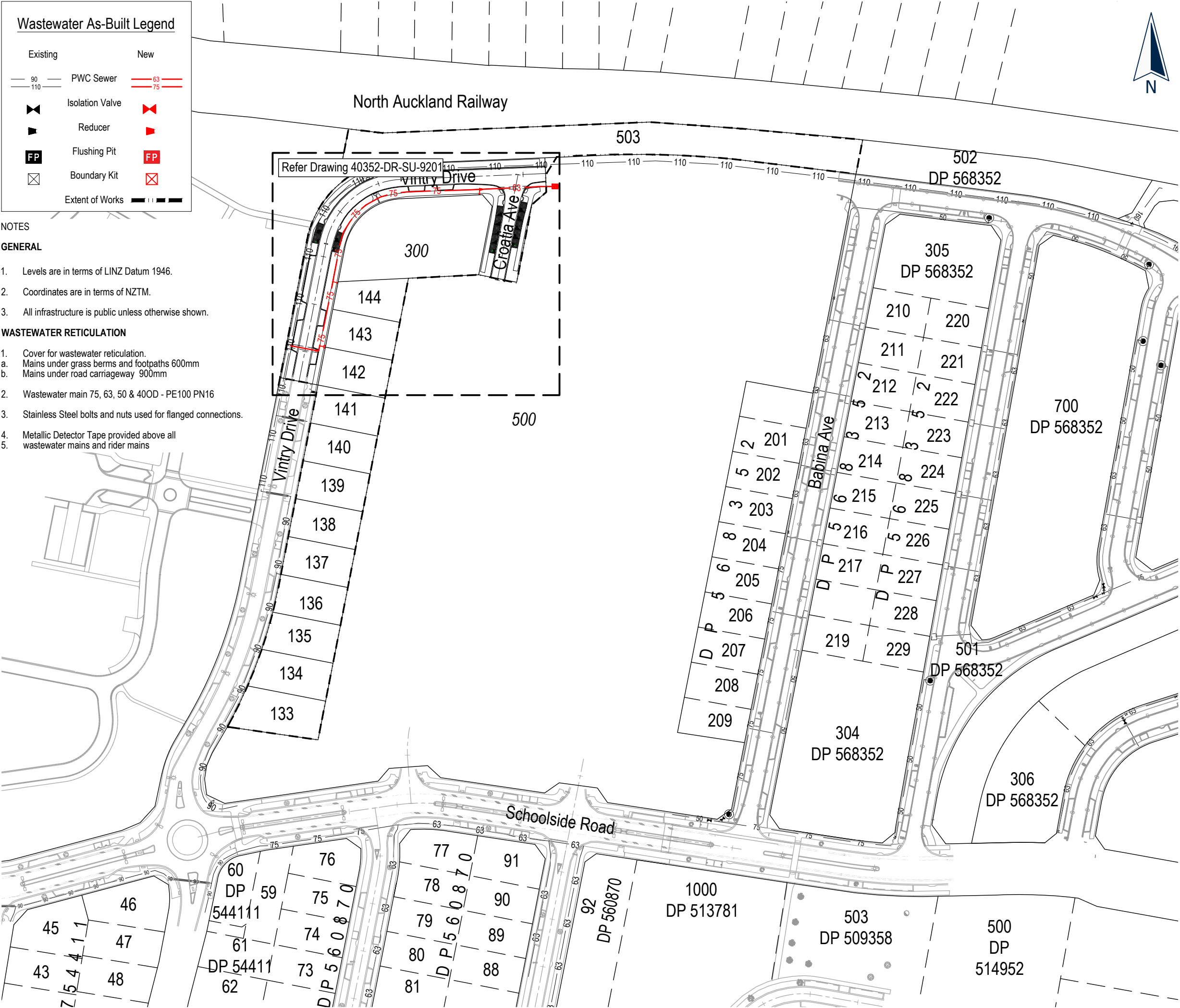

Wastewater As-Built Legend

Existing

New

90

110

PWC Sewer

63

75

Isolation Valve

FP

Reducer

FP

Flushing Pit

FP

Boundary Kit

Extent of Works

- NOTES
- GENERAL
1.

Levels are in terms of LINZ Datum 1946.
2.

Coordinates are in terms of NZTM.
3.

All infrastructure is public unless otherwise shown.
- WASTEWATER RETICULATION
1.

Cover for wastewater reticulation.
- a.

Mains under grass berms and footpaths 600mm
- b.

Mains under road carriageway 900mm
2.

Wastewater main 75, 63, 50 & 400D - PE100 PN16
3.

Stainless Steel bolts and nuts used for flanged connections.
4.

Metallic Detector Tape provided above all wastewater mains and rider mains

This drawing and design remains the property of, and may not be reproduced or amended without the written permission of Cato Bolam Consultants Ltd. No liability shall be accepted for unauthorised use of this drawing and design.



ENG60388149 /BUN60318445

I certify that these As-Built Plans are an accurate record of the works undertaken and that:  
\* The Coordinates (X, Y) are in terms of NZTM on NZGD(2000), and are within ± 50mm.  
\* The levels (Z) are in terms of the Auckland 1946 (MSL) LINZ datum (DOSLI datum), and are within ± 10mm.

Signed: Registered Professional Surveyor

Date: 02/12/2022

Name: Kerry McPherson  
Phone : (09) 427 0072  
Email : KerryM@catobolam.co.nz



PLANNERS | SURVEYORS | ENGINEERS  
ARCHITECTS | ENVIRONMENTAL

Cabra Developments Limited  
22 Vintry Drive  
Huapai













Overall  
PWC Sewer  
As-Built Plan

FOR COMPLETION

No.	REVISION (DESCRIPTIONS)	NAME	DATE
0	Issued For Completion	K.Middeldorp	27/07/2022
1	Issued For Completion	K.Middeldorp	22/11/2022
2	Issued For Completion	K.Middeldorp	02/12/2022
SURVEYED		H.Baker	07/11/2022
DESIGNED		E.Green	06/07/2021
DRAWN		B.Nel	10/11/2022
DATE		10/11/2022	
ORIGINAL SCALE		1:1500	
ORIGINAL SIZE		A3	
DRAWING NO.			REVISION
40352-DR-SU-9200			2



# Wastewater As-Built Legend

Existing	New
 90 PWC Sewer	 63
 110	 75
 Isolation Valve	 Reducer
 Flushing Pit	 Flushing Pit
 Boundary Kit	 Boundary Kit
 Extent of Works	 Extent of Works

## Wastewater Assets Coordinate Table

Name	mN	mE
IV1	5929148.67	1737466.71
FP1	5929214.75	1737566.41

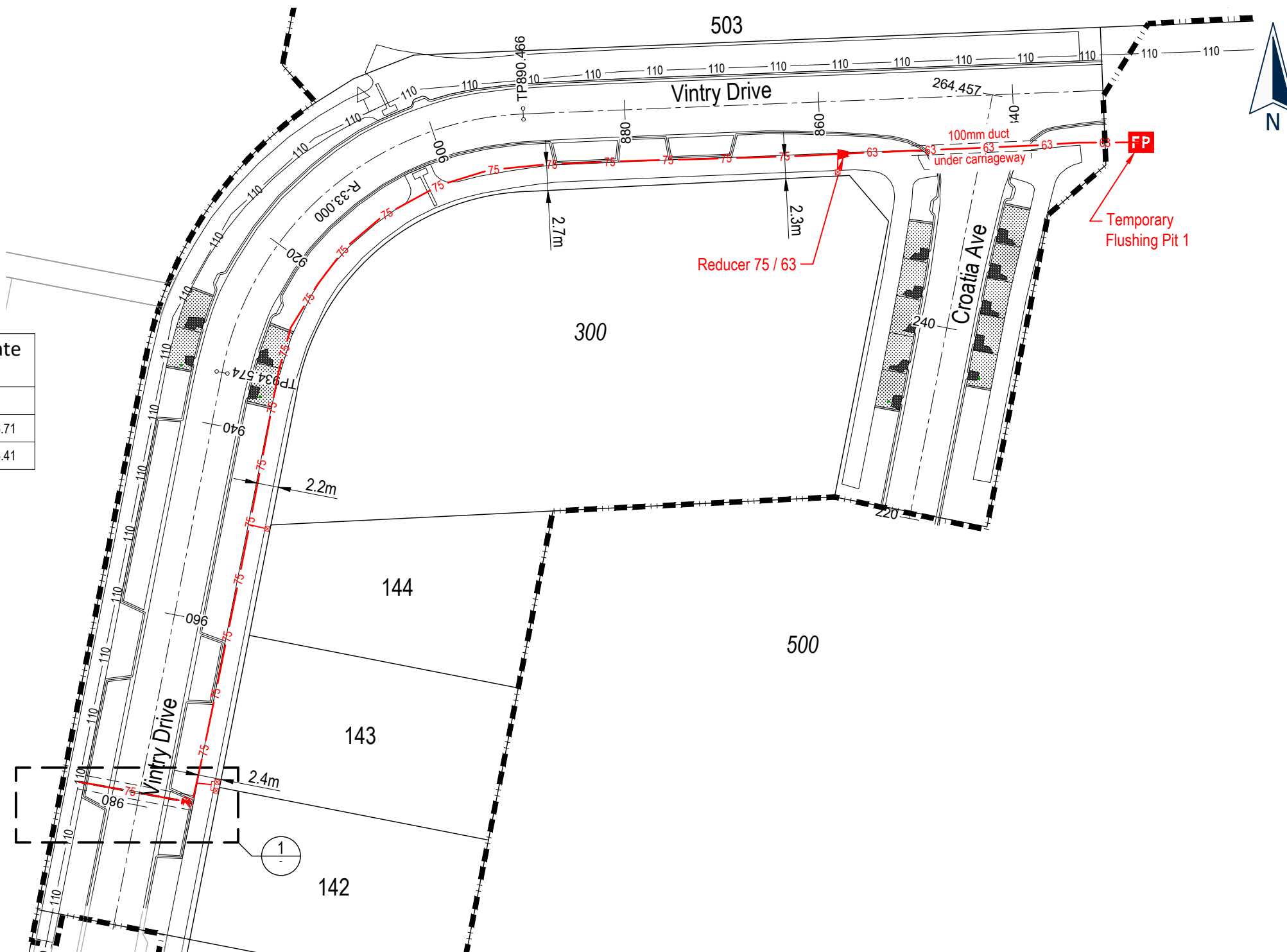

Connection to existing reticulation carried out by Watercare approved contractor

150mm duct under carriageway

IV 1

## Enlarged Wastewater Crossing Detail

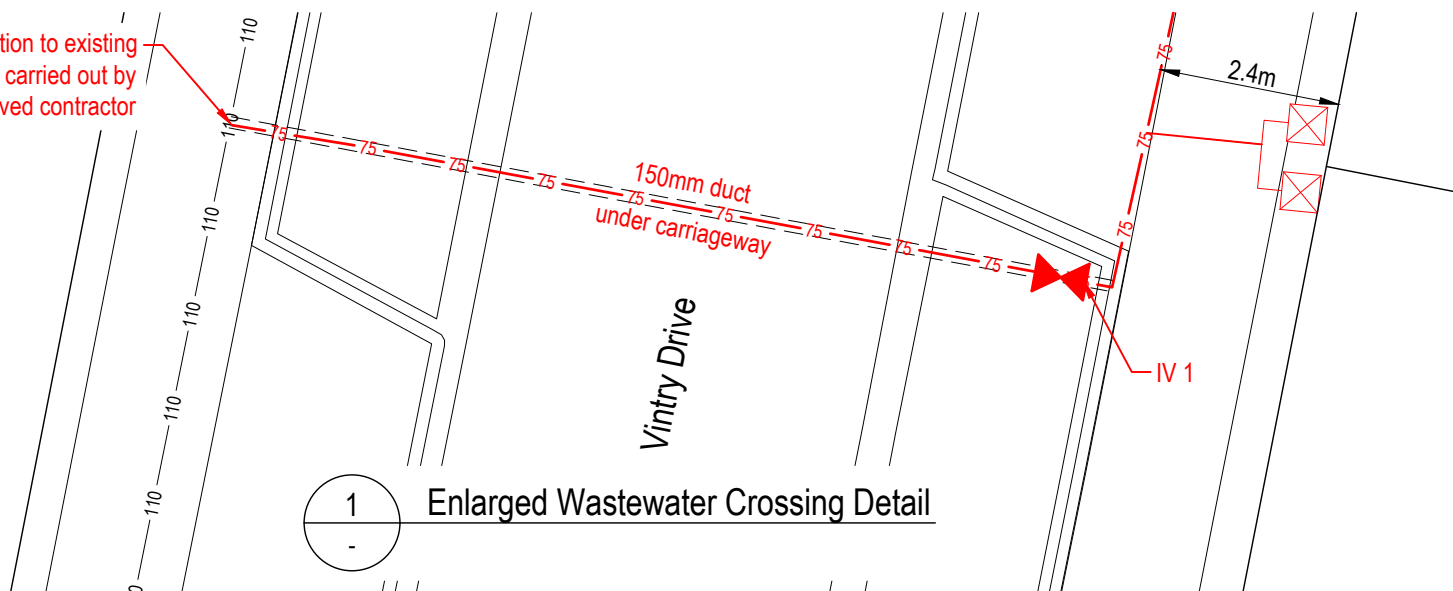

This drawing and design remains the property of, and may not be reproduced or amended without the written permission of Cato Bolam Consultants Ltd. No liability shall be accepted for unauthorised use of this drawing and design.



ENG60388149 /BUN60318445

I certify that these As-Built Plans are an accurate record of the works undertaken and that:

- \* The Coordinates (X, Y) are in terms of NZTM on NZGD(2000), and are within  $\pm 50$ mm.
- \* The levels (Z) are in terms of the Auckland 1946 (MSL) LINZ datum (DOSLI datum), and are within  $\pm 10$ mm.

Signed:  Registered Professional Surveyor

Date: 02/12/2022

Name: Kerryn McPherson  
Phone : (09) 427 0072  
Email : KerrynM@catobolam.co.nz



PLANNERS | SURVEYORS | ENGINEERS  
ARCHITECTS | ENVIRONMENTAL

Cabra Developments Limited  
22 Vintry Drive  
Huapai

Enlarged  
PWC Sewer  
As-Built Plan

## FOR COMPLETION

No.	REVISION (DESCRIPTIONS)	NAME	DATE
0	Issued For Completion	K.Middeldorp	27/07/2022
1	Issued For Completion	K.Middeldorp	22/11/2022
2	Issued For Completion	K.Middeldorp	02/12/2022
SURVEYED		H.Baker	07/11/2022
DESIGNED		E.Greene	06/07/2021
DRAWN		B.Nel	10/11/2022
DATE		10/11/2022	ORIGINAL SCALE
			1:500
			ORIGINAL SIZE
			A3
DRAWING NO.			REVISION
40352-DR-SU-9201			2

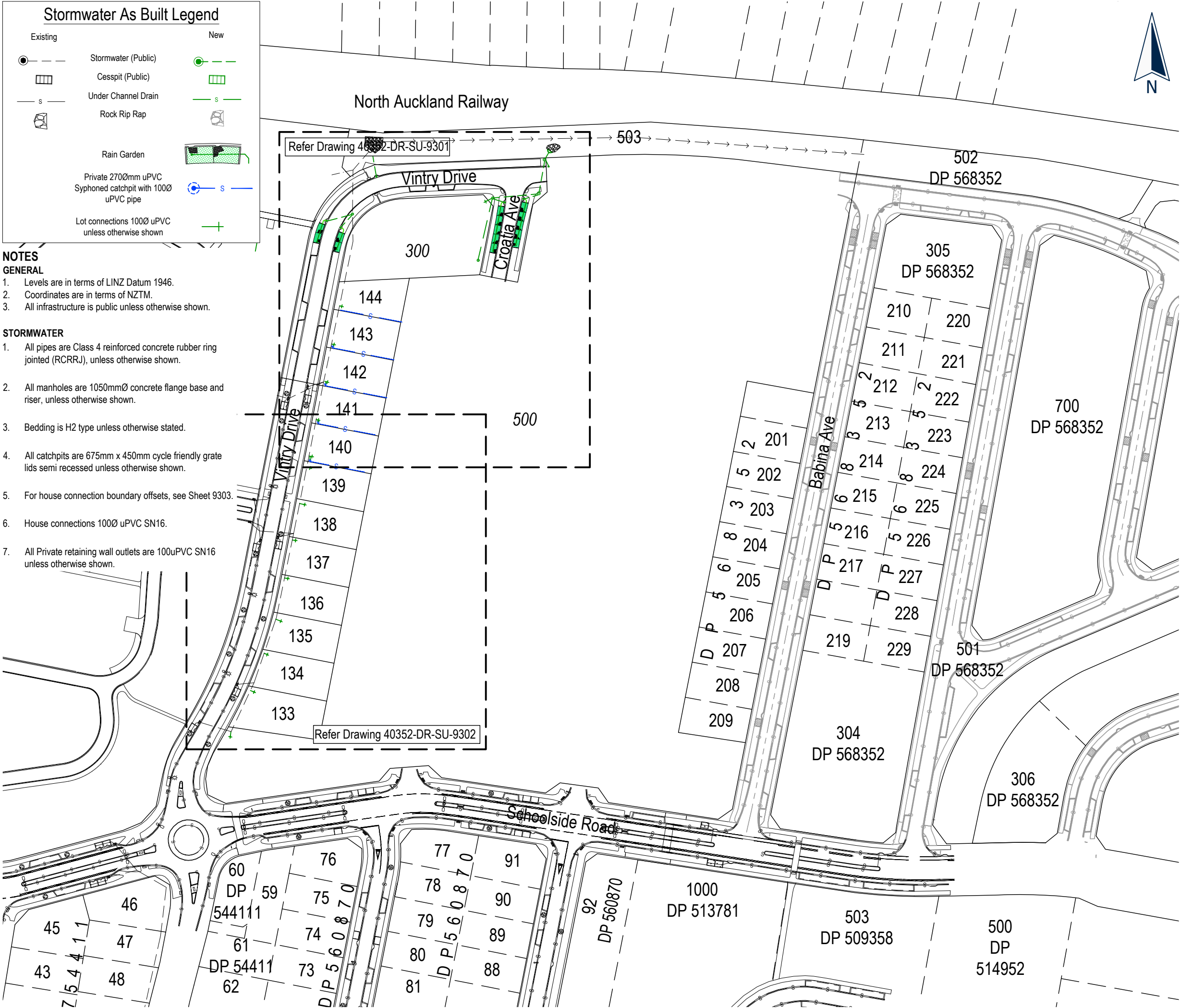

This drawing and design remains the property of, and may not be reproduced or amended without the written permission of Cato Bolam Consultants Ltd. No liability shall be accepted for unauthorised use of this drawing and design.



ENG60388149 /BUN60318445

I certify that these As-Built Plans are an accurate record of the works undertaken and that:  
\* The Coordinates (X, Y) are in terms of NZTM on NZGD(2000), and are within ± 50mm.  
\* The levels (Z) are in terms of the Auckland 1946 (MSL) LINZ datum (DOSLI datum), and are within ± 10mm.

Signed: *Kneip*  
Registered Professional Surveyor

Date: 02/12/2022

Name: Kerryn McPherson  
Phone : (09) 427 0072  
Email : KerrynM@catobolam.co.nz



PLANNERS | SURVEYORS | ENGINEERS  
ARCHITECTS | ENVIRONMENTAL

Cabra Developments Limited  
22 Vintry Drive  
Huapai

Overall  
Stormwater  
As-Built Plan

FOR COMPLETION

No.	REVISION (DESCRIPTIONS)	NAME	DATE
0	Issued For Completion	K.Middeldorp	02/12/2022
SURVEYED		H.Baker	07/11/2022
DESIGNED		E.Green	06/07/2021
DRAWN		B.Nel	10/11/2022
DATE		ORIGINAL SCALE	ORIGINAL SIZE
10/11/2022		1:1500	A3
DRAWING NO.			REVISION
40352-DR-SU-9300			0

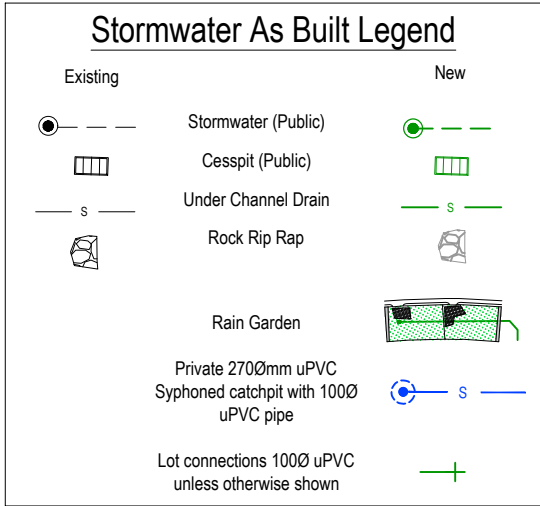

**NOTES**  
**GENERAL**

1. Levels are in terms of LINZ Datum 1946.
2. Coordinates are in terms of NZTM.
3. All infrastructure is public unless otherwise shown.

**STORMWATER**

1. All pipes are Class 4 reinforced concrete rubber ring jointed (RCRRJ), unless otherwise shown.
2. All manholes are 1050mmØ concrete flange base and riser, unless otherwise shown.
3. Bedding is H2 type unless otherwise stated.
4. All catchpits are 675mm x 450mm cycle friendly grate lids semi recessed unless otherwise shown.
5. For house connection boundary offsets, see Sheet 9303.
6. House connections 100Ø uPVC SN16.
7. All Private retaining wall outlets are 100uPVC SN16 unless otherwise shown.

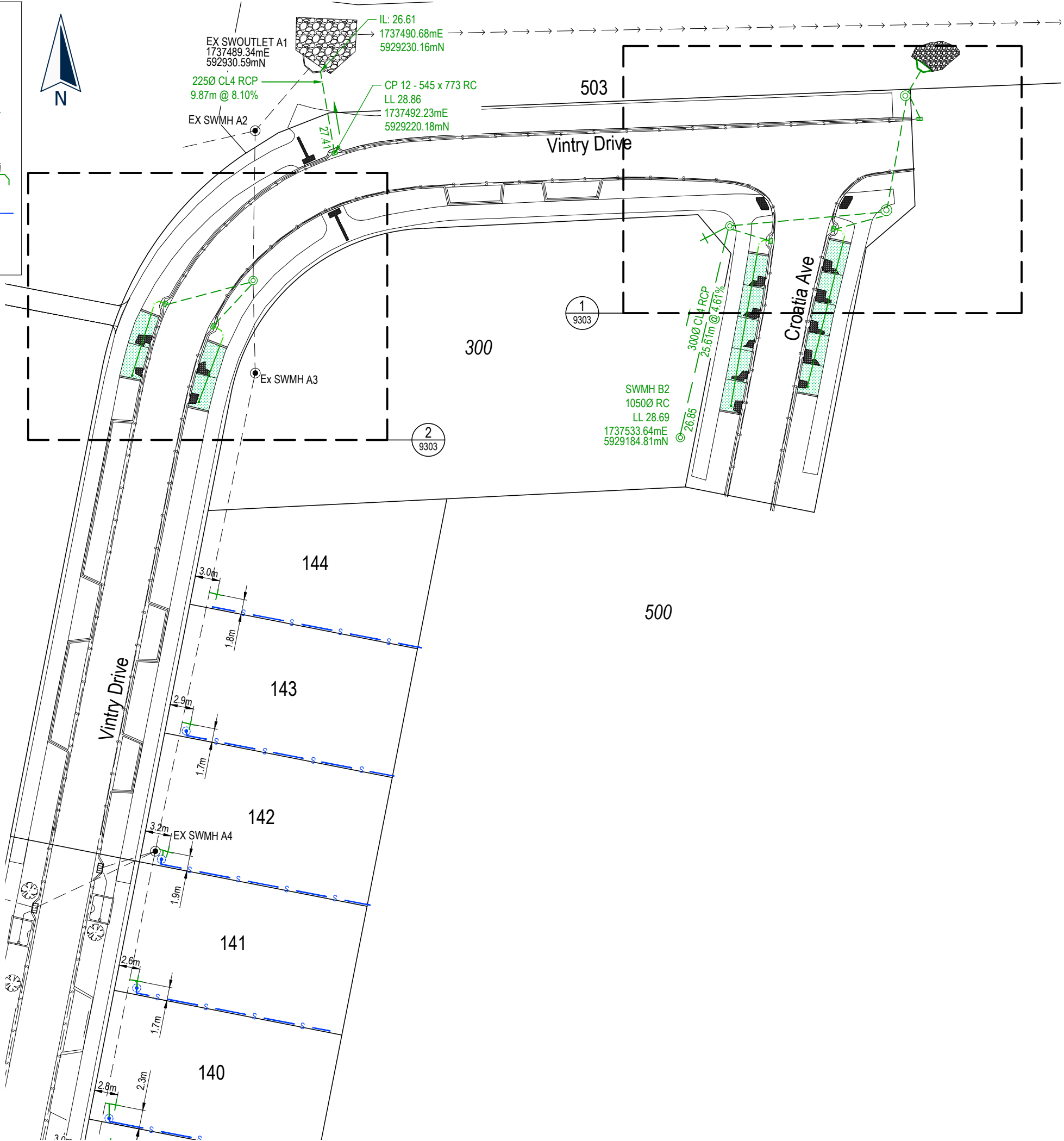

This drawing and design remains the property of, and may not be reproduced or amended without the written permission of Cato Bolam Consultants Ltd. No liability shall be accepted for unauthorised use of this drawing and design.



ENG60388149 /BUN60318445

I certify that these As-Built Plans are an accurate record of the works undertaken and that:

- \* The Coordinates (X, Y) are in terms of NZTM on NZGD(2000), and are within ± 50mm.
- \* The levels (Z) are in terms of the Auckland 1946 (MSL) LINZ datum (DOSLI datum), and are within ± 10mm.

Signed: .....  
Licensed Cadastral Surveyor

Date: 09/12/2022

Name: Brad Mowat  
Phone : (09) 427 0072  
Email : BradM@catobolam.co.nz



PLANNERS | SURVEYORS | ENGINEERS  
ARCHITECTS | ENVIRONMENTAL

**Cabra Developments Limited**  
**22 Vintry Drive**  
**Huapai**

**Enlarged**  
**Stormwater As-Built Plan**  
**Sheet 1**

**FOR COMPLETION**

No.	REVISION (DESCRIPTIONS)	NAME	DATE
0	Issued For Completion	K.Middeldorp	02/12/2022
1	Coordinates added to EX SWOUTLET A1	K.Middeldorp	09/12/2022
SURVEYED		H.Baker	07/11/2022
DESIGNED		E.Greene	06/07/2021
DRAWN		B.Nel	10/11/2022
DATE		ORIGINAL SCALE	ORIGINAL SIZE
10/11/2022		1:500	A3
DRAWING NO.			REVISION
40352-DR-SU-9301			1



Stormwater As Built Legend

Existing

New

Stormwater (Public)

Cesspit (Public)

Under Channel Drain

Rock Rip Rap

Rain Garden

Private 270Ømm uPVC  
Syphoned catchpit with 100Ø  
uPVC pipe

Lot connections 100Ø uPVC  
unless otherwise shown

Stormwater (Public)

Cesspit (Public)

Under Channel Drain

Rock Rip Rap

Rain Garden

Private 270Ømm uPVC  
Syphoned catchpit with 100Ø  
uPVC pipe

Lot connections 100Ø uPVC  
unless otherwise shown

NOTES  
GENERAL

- Levels are in terms of LINZ Datum 1946.
- Coordinates are in terms of NZTM.
- All infrastructure is public unless otherwise shown.

STORMWATER

- All pipes are Class 4 reinforced concrete rubber ring jointed (RCRRJ), unless otherwise shown.
- All manholes are 1050mmØ concrete flange base and riser, unless otherwise shown.
- Bedding is H2 type unless otherwise stated.
- All catchpits are 675mm x 450mm cycle friendly grate lids semi recessed unless otherwise shown.
- For house connection boundary offsets, see Sheet 9303.
- House connections 100Ø uPVC SN16.
- All Private retaining wall outlets are 100uPVC SN16 unless otherwise shown.



This drawing and design remains the property of, and may not be reproduced or amended without the written permission of Cato Bolam Consultants Ltd. No liability shall be accepted for unauthorised use of this drawing and design.



ENG60388149 /BUN60318445

I certify that these As-Built Plans are an accurate record of the works undertaken and that:

- \* The Coordinates (X, Y) are in terms of NZTM on NZGD(2000), and are within ± 50mm.
- \* The levels (Z) are in terms of the Auckland 1946 (MSL) LINZ datum (DOSLI datum), and are within ± 10mm.

Signed:  Registered Professional Surveyor

Date: 02/12/2022

Name: Kerry McPherson  
Phone : (09) 427 0072  
Email : KerryM@catabolam.co.nz



PLANNERS | SURVEYORS | ENGINEERS  
ARCHITECTS | ENVIRONMENTAL

Cabra Developments Limited  
22 Vintry Drive  
Huapai

Enlarged  
Stormwater As-Built Plan  
Sheet 2

FOR COMPLETION

No.	REVISION (DESCRIPTIONS)	NAME	DATE
0	Issued For Completion	K.Middeldorp	02/12/2022
SURVEYED		H.Baker	07/11/2022
DESIGNED		E.Greene	06/07/2021
DRAWN		B.Nel	10/11/2022
DATE		ORIGINAL SCALE	ORIGINAL SIZE
10/11/2022		1:500	A3
DRAWING NO.			REVISION
40352-DR-SU-9302			0



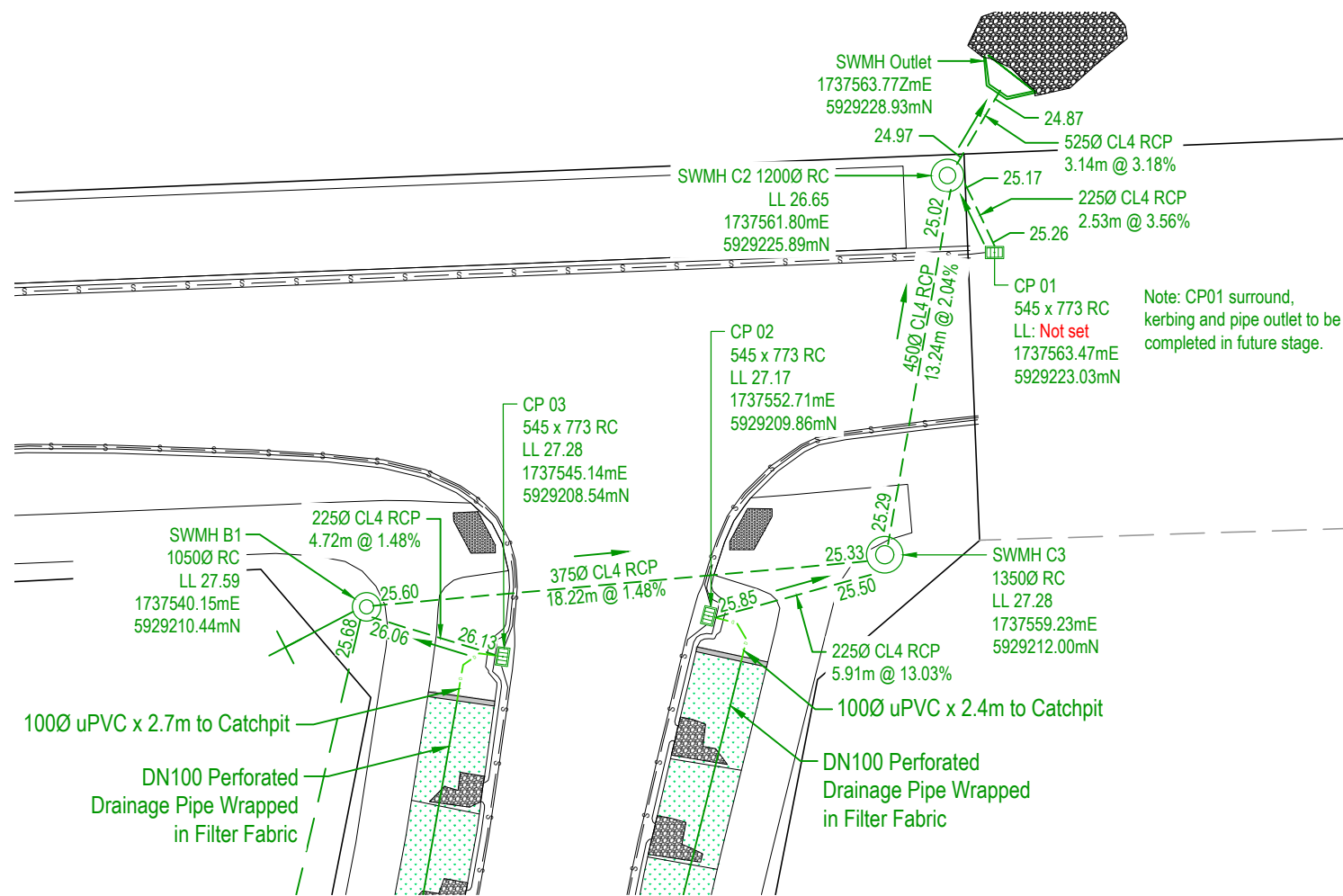

1 Stormwater Enlarged Detail  
9301 Scale: 1:250

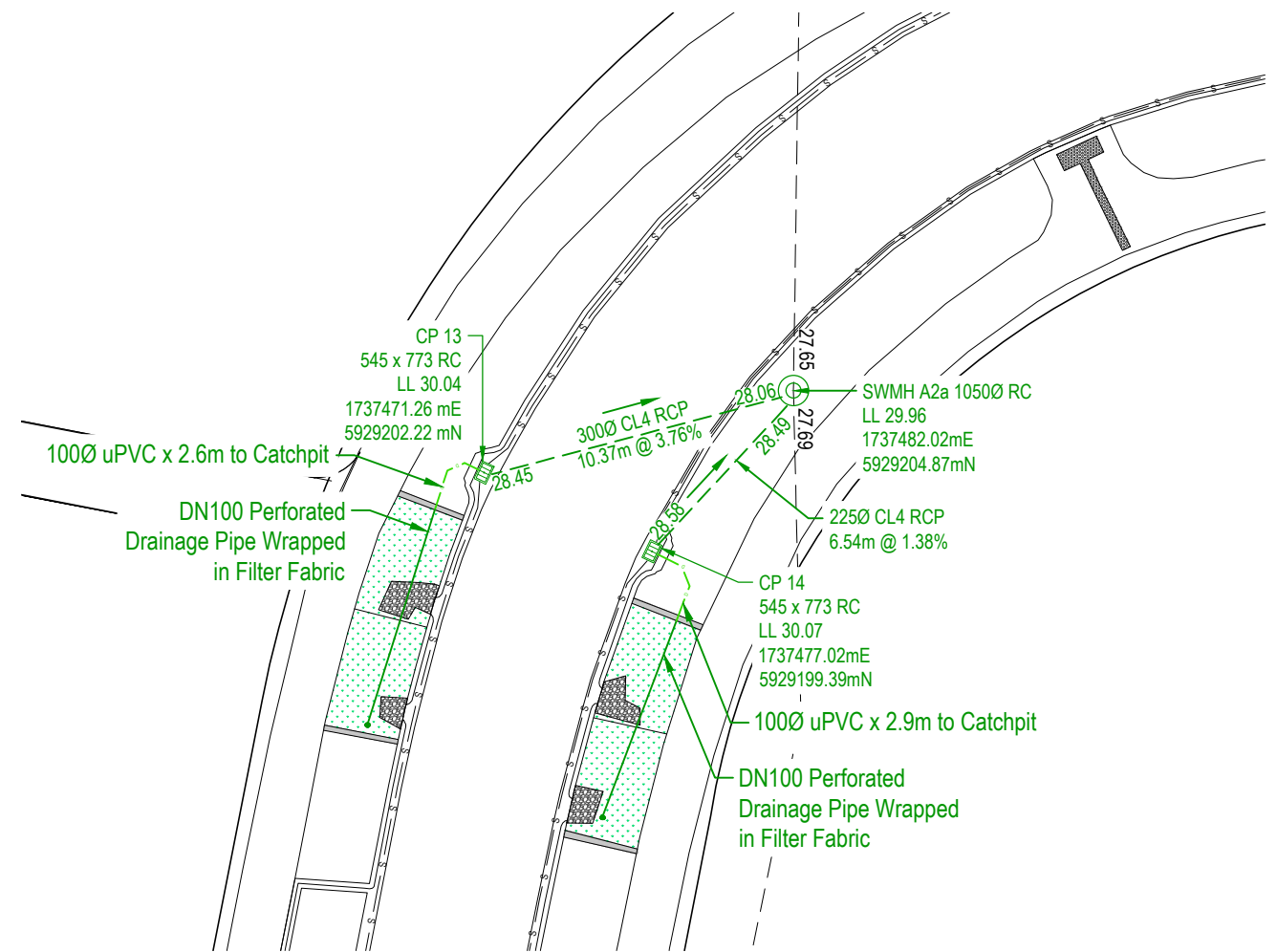

2 Stormwater Enlarged Detail  
9301 Scale: 1:250

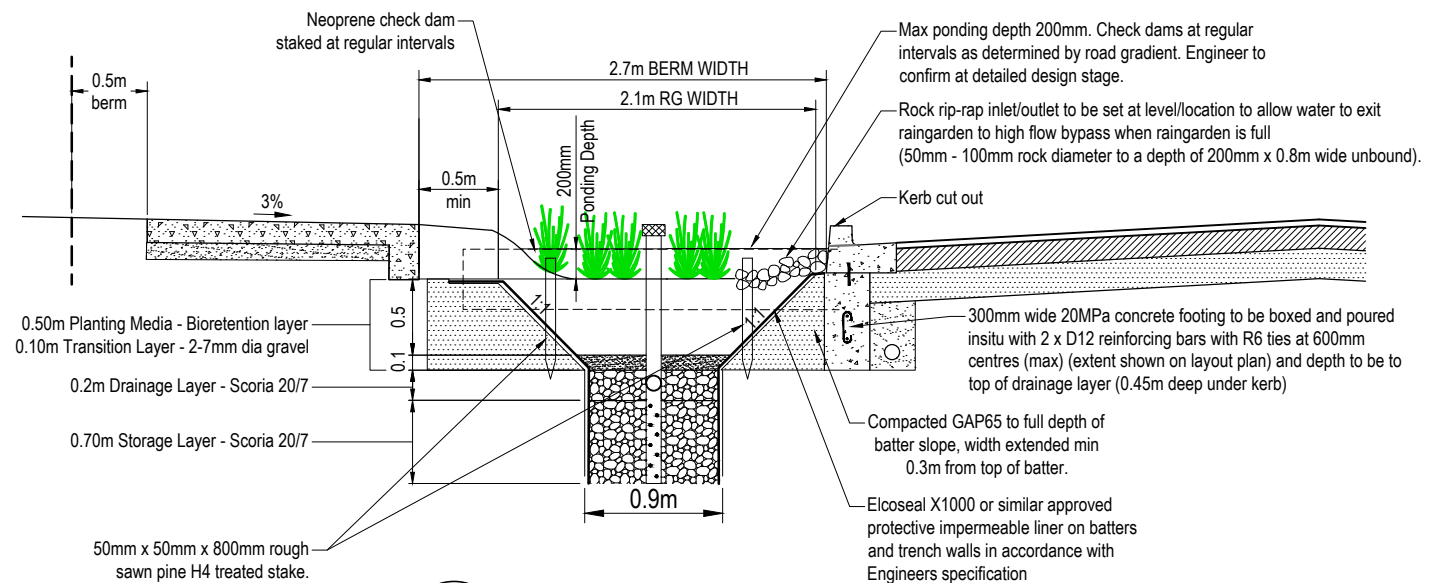

3 Typical Raingarden Cross Section  
- Scale: 1:50

ENG60388149 /BUN60318445

I certify that these As-Built Plans are an accurate record of the works undertaken and that:

- \* The Coordinates (X, Y) are in terms of NZTM on NZGD(2000), and are within  $\pm 50$ mm.
- \* The levels (Z) are in terms of the Auckland 1946 (MSL) LINZ datum (DOSLI datum), and are within  $\pm 10$ mm.

Signed:   
Licensed Cadastral Surveyor

Date: 09/12/2022

Name: Brad Mowat  
Phone : (09) 427 0072  
Email : BradM@catobolam.co.nz

**Cato Bolam**  
creating great places

PLANNERS | SURVEYORS | ENGINEERS  
ARCHITECTS | ENVIRONMENTAL

**CABRA**  
Land & Property Development

This drawing and design remains the property of, and may not be reproduced or amended without the written permission of Cato Bolam Consultants Ltd. No liability shall be accepted for unauthorised use of this drawing and design.

Cabra Developments Limited  
22 Vintry Drive  
Huapai

Enlarged  
Stormwater & Raingarden  
As-Built Details

No.	REVISION (DESCRIPTIONS)	NAME	DATE
0	Issued For Completion	K.McPherson	02/12/2022
1	Amended SWMH C2 outlet pipe	B.Mowat	09/12/2022

FOR COMPLETION

	NAME	DATE
SURVEYED	H.Baker	07/11/2022
DESIGNED	E.Greene	06/07/2021
DRAWN	B.Nel	01/12/2022

DATE	ORIGINAL SCALE	ORIGINAL SIZE
01/12/2022	As Drawn	A3

DRAWING NO.	REVISION
40352-DR-SU-9303	1

C:\12\ds\synergy\data\CATOAPP\140352 - Cabra Stg 2 Sub Precinct A. 10495\Technical\Drawings\As-Built Drawings\40352-DR-SU-9300-9302 Stormwater As Built

Water Reticulation As-Built Legend

Existing	New
125	180
280	125
	63

NOTES

GENERAL

1. Coordinates are in terms of NZTM 2000.

WATER RETICULATION

- Cover for water reticulation.
  - Mains under grass berms and footpaths 600mm
  - Mains under road carriageway 900mm
- Watermain 125, 180 & 225 OD - PE100 PN12.5
- All rider mains 63 OD - PE80 PN12.5
- Stainless Steel bolts and nuts used for flanged connections.
- Metallic Detector Tape provided above all water mains and rider mains

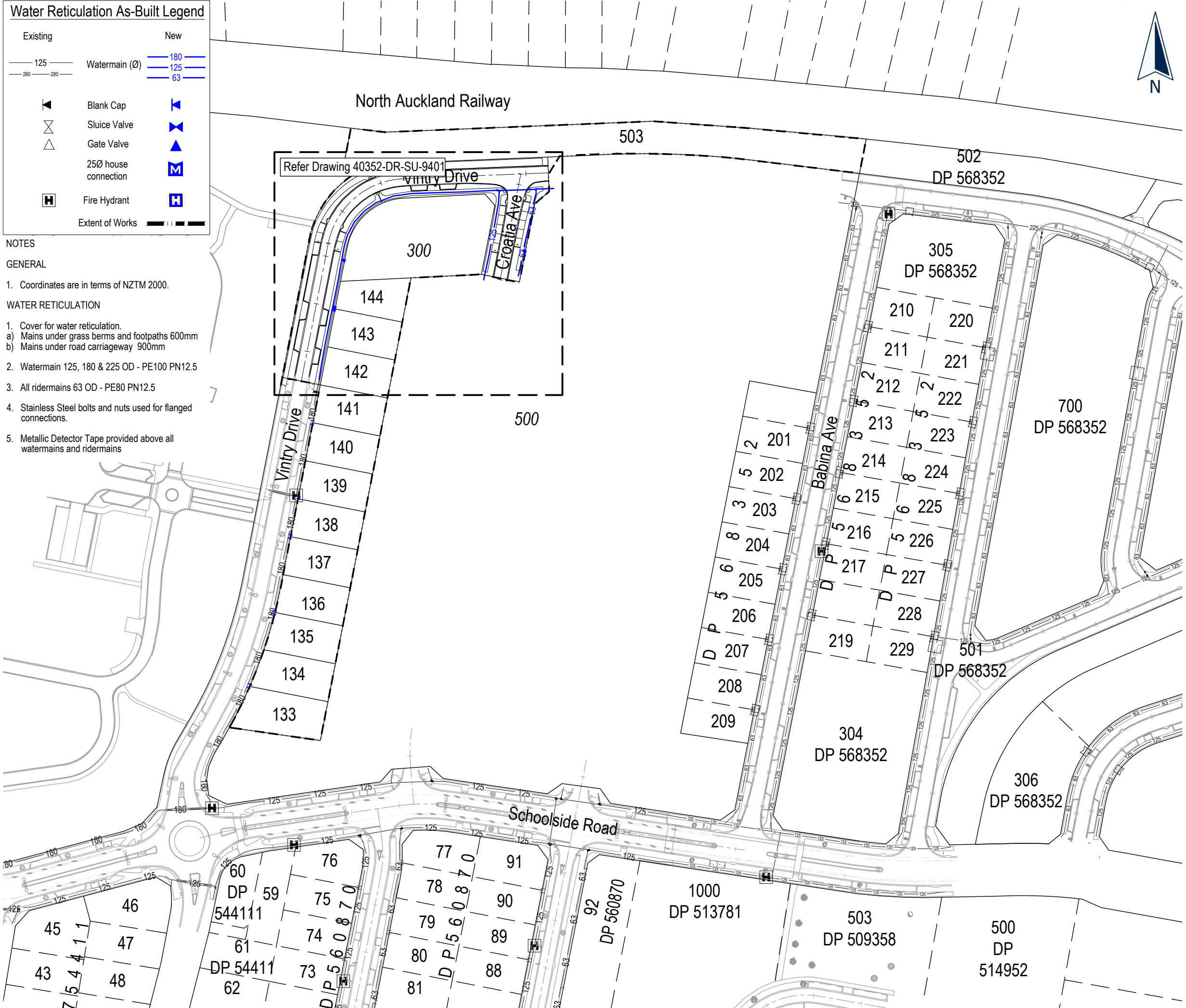

This drawing and design remains the property of, and may not be reproduced or amended without the written permission of Cato Bolam Consultants Ltd. No liability shall be accepted for unauthorised use of this drawing and design.



ENG60388149 /BUN60318445

I certify that these As-Built Plans are an accurate record of the works undertaken and that:

- \* The Coordinates (X, Y) are in terms of NZTM on NZGD(2000), and are within  $\pm 50$ mm.
- \* The levels (Z) are in terms of the Auckland 1946 (MSL) LINZ datum (DOSLI datum), and are within  $\pm 10$ mm.

Signed: Registered Professional Surveyor

Date: 02/12/2022

Name: Kerryn McPherson  
Phone : (09) 427 0072  
Email : KerrynM@catobolam.co.nz



PLANNERS | SURVEYORS | ENGINEERS  
ARCHITECTS | ENVIRONMENTAL

Cabra Developments Limited  
22 Vintry Drive  
Huapai











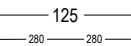
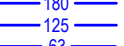



Overall  
Water Reticulation  
As-Built Plan

FOR COMPLETION

No.	REVISION (DESCRIPTIONS)	NAME	DATE
0	Issued For Completion	K.Middeldorp	27/07/2022
1	Issued For Completion	K.Middeldorp	22/11/2022
2	Issued For Completion	K.Middeldorp	02/12/2022
SURVEYED		H.Baker	07/11/2022
DESIGNED		E.Greene	06/07/2021
DRAWN		B.Nel	10/11/2022
DATE		10/11/2022	
ORIGINAL SCALE		1:1500	
ORIGINAL SIZE		A3	
DRAWING NO.			REVISION
40352-DR-SU-9400			2



Water Reticulation As-Built Legend

Existing	New
 125	 180
 280	 125
	
	
	
	
	
	

Water Assets Coordinate Table

Name	mN	mE
SV1	5929213.26	1737541.85
SV2	5929212.92	1737542.17
SV3	5929213.21	1737542.51
SV4	5929213.62	1737557.66
GV1	5929213.28	1737557.32
Hydrant 1	5929213.37	1737541.32

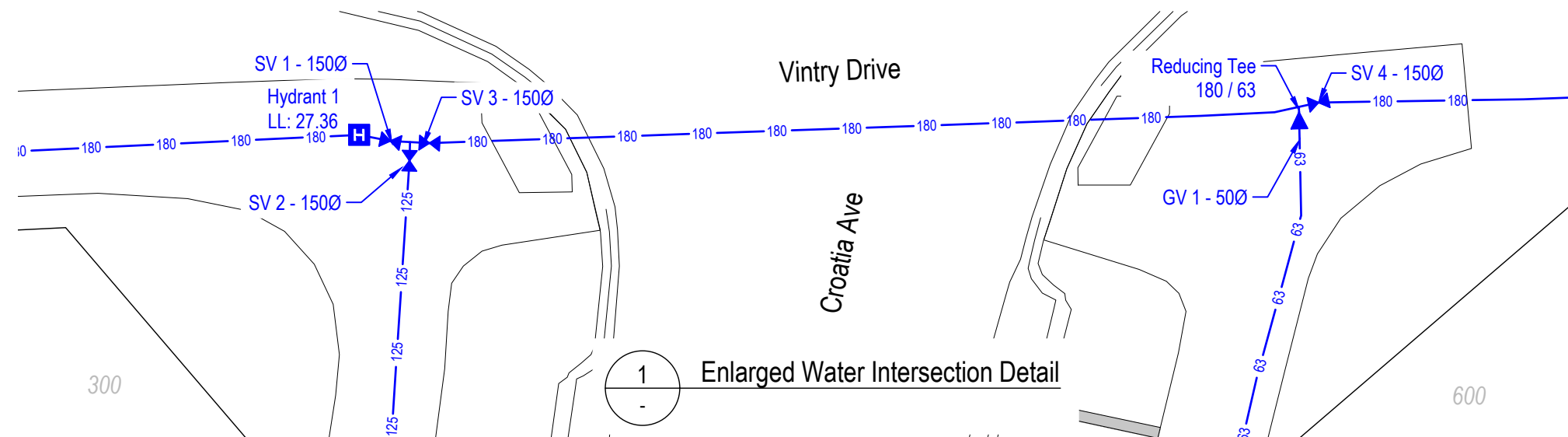
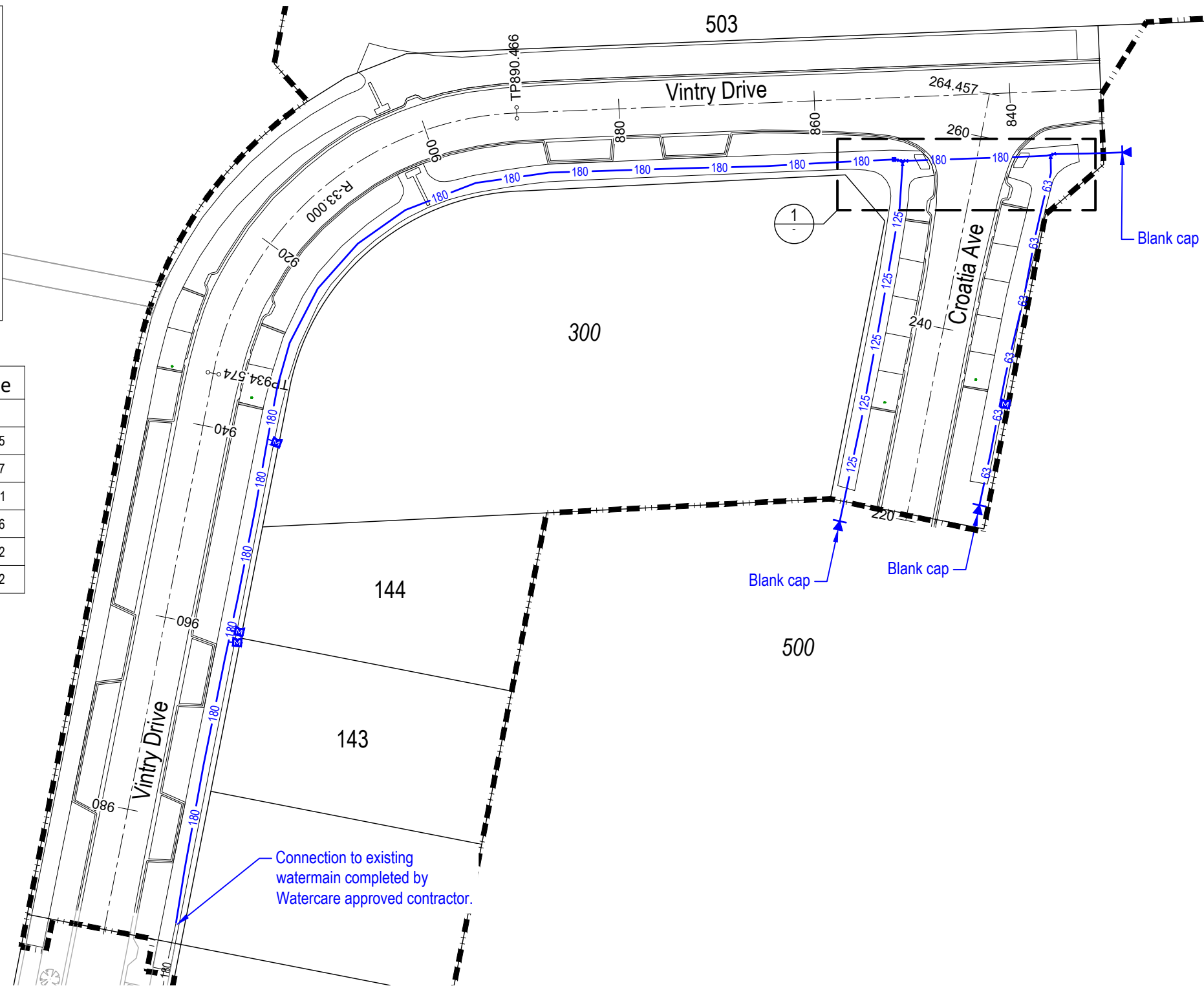

This drawing and design remains the property of, and may not be reproduced or amended without the written permission of Cato Bolam Consultants Ltd. No liability shall be accepted for unauthorised use of this drawing and design.



ENG60388149 /BUN60318445

I certify that these As-Built Plans are an accurate record of the works undertaken and that:

- \* The Coordinates (X, Y) are in terms of NZTM on NZGD(2000), and are within  $\pm 50$ mm.
- \* The levels (Z) are in terms of the Auckland 1946 (MSL) LINZ datum (DOSLI datum), and are within  $\pm 10$ mm.

Signed:   
Registered Professional Surveyor

Date: 02/12/2022

Name: Kerryn McPherson  
Phone : (09) 427 0072  
Email : KerrynM@catobolam.co.nz



PLANNERS | SURVEYORS | ENGINEERS  
ARCHITECTS | ENVIRONMENTAL

Cabra Developments Limited  
22 Vintry Drive  
Huapai

Enlarged  
Water Reticulation  
As-Built Plan

FOR COMPLETION

No.	REVISION (DESCRIPTIONS)	NAME	DATE
0	Issued For Completion	K.Middeldorp	27/07/2022
1	Issued For Completion	K.Middeldorp	22/11/2022
2	Issued For Completion	K.Middeldorp	02/12/2022
SURVEYED		H.Baker	07/11/2022
DESIGNED		E.Greene	06/07/2021
DRAWN		B.Nel	10/11/2022
DATE		10/11/2022	
ORIGINAL SCALE		1:500	
ORIGINAL SIZE		A3	
DRAWING NO.			REVISION
40352-DR-SU-9401			2

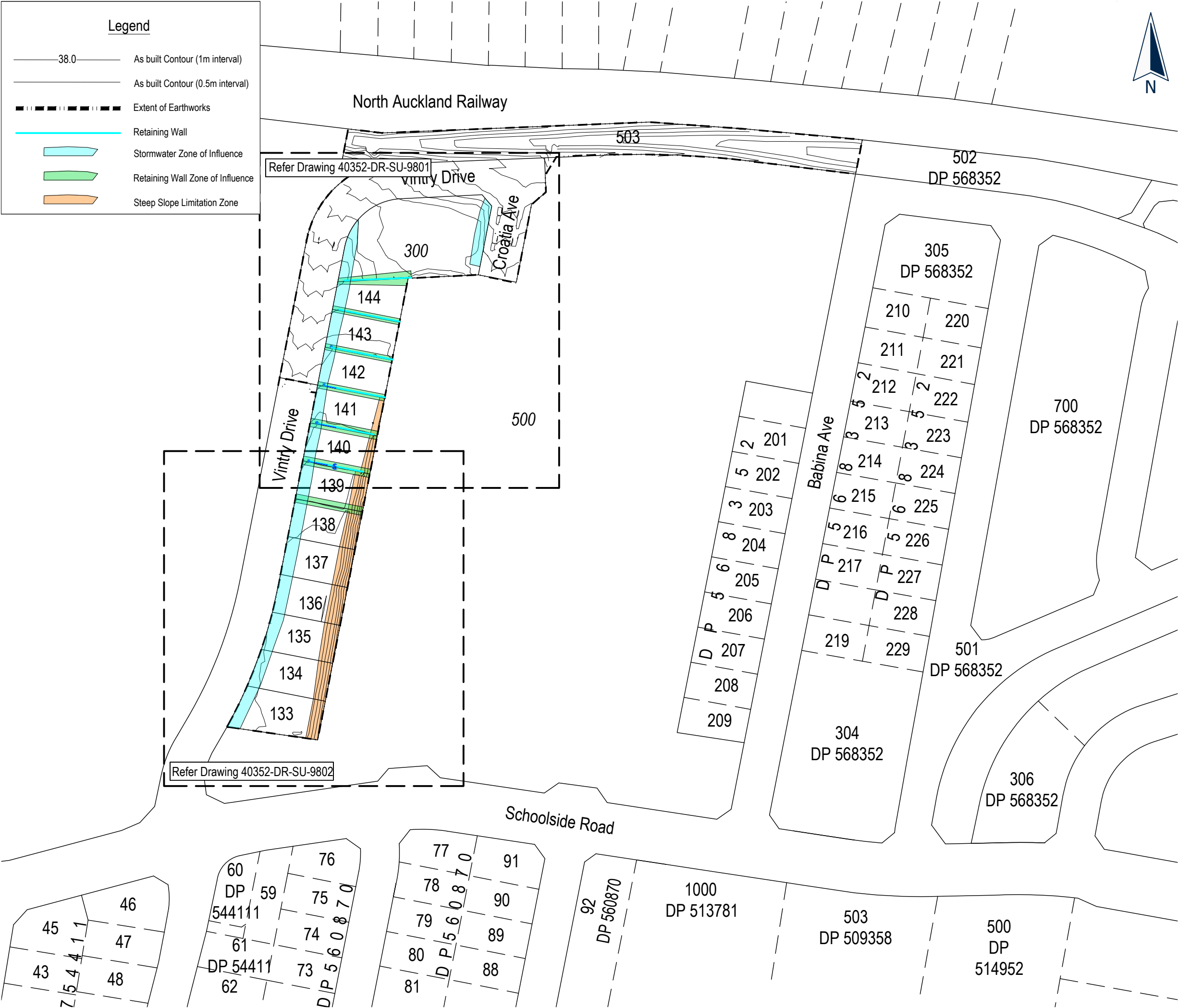

This drawing and design remains the property of, and may not be reproduced or amended without the written permission of Cato Bolam Consultants Ltd. No liability shall be accepted for unauthorised use of this drawing and design.



ENG60388149 / BUN60318445

I certify that these As-Built Plans are an accurate record of the works undertaken and that:

- \* The Coordinates (X, Y) are in terms of NZTM on NZGD(2000), and are within  $\pm 50$ mm.
- \* The levels (Z) are in terms of the Auckland 1946 (MSL) LINZ datum (DOSLI datum), and are within  $\pm 10$ mm.

Signed:   
Registered Professional Surveyor

Date: 02/12/2022

Name: Kerryn McPherson  
Phone : (09) 427 0072  
Email : KerrynM@catobolam.co.nz



PLANNERS | SURVEYORS | ENGINEERS  
ARCHITECTS | ENVIRONMENTAL

Cabra Developments Limited  
22 Vintly Drive  
Huapai

Overall  
Zone Of Influence  
As-Built Plan

FOR COMPLETION

No.	REVISION (DESCRIPTIONS)	NAME	DATE
0	Issued For Completion	K.Middeldorp	02/12/2022
SURVEYED		H.Baker	07/11/2022
DESIGNED		E.Greene	06/07/2021
DRAWN		B.Nel	09/11/2022
DATE		ORIGINAL SCALE	ORIGINAL SIZE
09/11/2022		1:1500	A3
DRAWING NO.			REVISION
40352-DR-SU-9800			0



Legend

38.0

As built Contour (1m interval)

As built Contour (0.5m interval)

Extent of Earthworks

Retaining Wall

Stormwater Zone of Influence

Retaining Wall Zone of Influence

Steep Slope Limitation Zone



This drawing and design remains the property of, and may not be reproduced or amended without the written permission of Cato Bolam Consultants Ltd. No liability shall be accepted for unauthorised use of this drawing and design.

CABRA

Land & Property Development

ENG60388149 /BUN60318445

I certify that these As-Built Plans are an accurate record of the works undertaken and that:

\* The Coordinates (X, Y) are in terms of NZTM on NZGD(2000), and are within ± 50mm.

\* The levels (Z) are in terms of the Auckland 1946 (MSL) LINZ datum (DOSLI datum), and are within ± 10mm.

Signed:

Registered Professional Surveyor

Date: 02/12/2022

Name: Kerryn McPherson

Phone : (09) 427 0072

Email : KerrynM@catobolam.co.nz

Cato Bolam

creating great places

PLANNERS | SURVEYORS | ENGINEERS

ARCHITECTS | ENVIRONMENTAL

Cabra Developments Limited

22 Vintry Drive

Huapai

Enlarged Zone Of Influence

As-Built Plan

Sheet 1

FOR COMPLETION

No.	REVISION (DESCRIPTIONS)	NAME	DATE
0	Issued For Completion	K.Middeldorp	02/12/2022

SURVEYED	H.Baker	07/11/2022
DESIGNED	E.Greene	06/07/2021
DRAWN	B.Nel	09/11/2022

DATE	ORIGINAL SCALE	ORIGINAL SIZE
09/11/2022	1:500	A3

DRAWING NO.	REVISION
40352-DR-SU-9801	0

C:\120synergy\workspaces\data\CA\TAPPI\40352 - cabra stj 2 sub preend a - 10495\technical\Drawings\as-built drawings\40352-DR-SU-9801-9802 SW & RW ZOI As-Built

Legend

38.0

As built Contour (1m interval)

As built Contour (0.5m interval)

Extent of Earthworks

Retaining Wall

Stormwater Zone of Influence

Retaining Wall Zone of Influence

Steep Slope Limitation Zone

1  
DP 533552

Vintry Drive

500

This drawing and design remains the property of, and may not be reproduced or amended without the written permission of Cato Bolam Consultants Ltd. No liability shall be accepted for unauthorised use of this drawing and design.

ENG60388149 /BUN60318445

I certify that these As-Built Plans are an accurate record of the works undertaken and that:

- \* The Coordinates (X, Y) are in terms of NZTM on NZGD(2000), and are within ± 50mm.
- \* The levels (Z) are in terms of the Auckland 1946 (MSL) LINZ datum (DOSLI datum), and are within ± 10mm.

Signed:  Registered Professional Surveyor

Date: 02/12/2022

Name: Kerryn McPherson  
Phone : (09) 427 0072  
Email : KerrynM@catobolam.co.nz

PLANNERS | SURVEYORS | ENGINEERS  
ARCHITECTS | ENVIRONMENTAL

Cabra Developments Limited  
22 Vintry Drive  
Huapai

Enlarged Zone Of Influence  
As-Built Plan  
Sheet 2

FOR COMPLETION

No.	REVISION (DESCRIPTIONS)	NAME	DATE
0	Issued For Completion	K.Middeldorp	02/12/2022
SURVEYED		H.Baker	07/11/2022
DESIGNED		E.Greene	06/07/2021
DRAWN		B.Nel	09/11/2022
DATE		ORIGINAL SCALE	ORIGINAL SIZE
09/11/2022		1:500	A3
DRAWING NO.			REVISION
40352-DR-SU-9802			0

C:\123synergy\work\spatialdata\CA\TAPPI\40352 - cabra stg 2 sub preend a\_10495\technical\Drawings\as-built drawings\40352-DR-SU-9802-9802 SW & RW ZOI As-Built